

Pony BMC: valve gate cold runner Guzzini Engineering solution for Bulk Molding Compound injection molding.

Pony BMC is a valve gate cold runner tailor made to the specific needs of BMC molding. It allows to minimize material scrap; eliminates the need of any secondary operation and facilitate the cleaning process with great savings in time and money. It features a completely hardened at 54 hrc body for an extreme erosion resistance.



Guzzini Engineering div. ne Acrilux Srl
62019 Recanati (MC) Italy
S.P. 571 Km 10,983
Tel: +39 07175891.1
Fax: +39 071757.4373/3595
Email: info@guzziniengineering.com



Pony BMC: main features

www.guzziniengineering.com

Versatility

the pneumatic piston avoid any oil contamination risk and therefore make it possible the molding for food and medical industry

Improved productivity

the valve gate completely shut the injection channel and produces smooth and even injection points, without any sprue: no need of secondary operations, faster cycle times and high production quality.

Easy to clean

the closing pin during the injection phase slides completely out of the flow: no material stagnation and faster and easier cleaning.

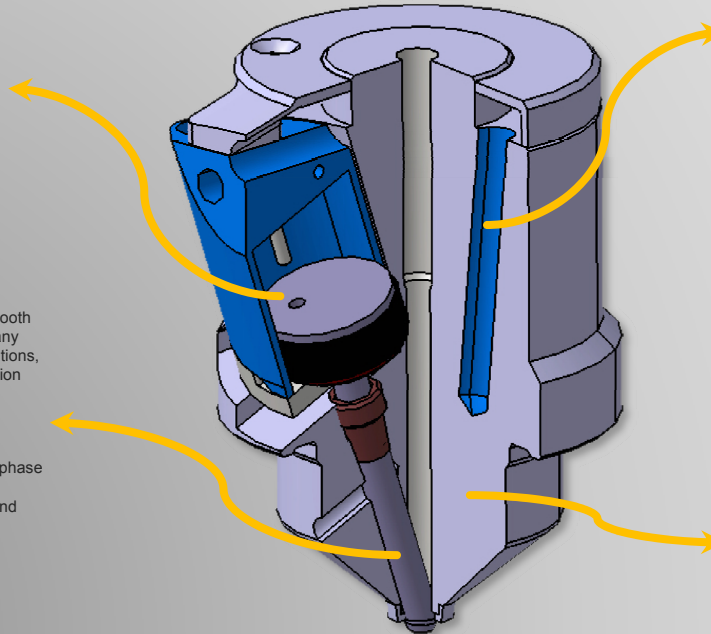

Cycle time optimization

the remarkable efficiency of the cooling system allows to perfectly separate the cold runner from the hot mould: reduced downtime and maximum efficiency of the cycle.

Perfect control of the production process

a thermocouple continuously monitors the runner and coolant temperature: high production quality and reduced start up times.

Completely hardened body

The completely hardened at 54 hrc body guarantee an extreme erosion resistance